

ADJUSTABLE REVERSIBLE JAW

Product #	Description	Length (in) (A)	Reach (in) (B)
J4230RJ	Adjustable Reversible Jaw	3-5/8	2-3/4

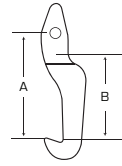

LEGS

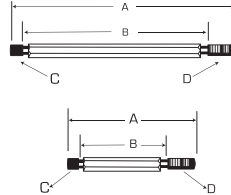

Product #	Description	Length (in) (A)	Shaft Length (in) (B)	Thread (C)	Thread (D)
J4240L	Medium Leg	14-3/16	12-19/64	1/2"-20 UNF	5/8"-18 UNF



SEPARATOR THREADED RODS

Product #	Length (in) (A)	Thread	For Separator
J4332R	8-1/2	5/8"-18 UNF	J4332
J4333R	10	3/4"-16 UNF	J4333

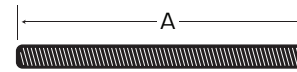

FORCING SCREW



Product #	Description	Hex Head (in)	Thread	Overall Length (in)	Detachable Tip
J4012	Forcing Screw	3/4	3/4"-10	11-13/16	J4012T



NOTE: ALL PROTO-EASE™ forcing screws are coated at the factory with the latest aerospace dry film lubricant designed to increase screw life, reduce wear and torque required for screw turning. It is recommended that a few drops of medium grade oil (SAE 30 or equivalent) be added to screw threads prior to every use. Screw threads must be kept clean at all times.